

NOTICE: THE DATA IN THIS DOCUMENT INCORPORATES PROPRIETARY RIGHTS OF THE ARCA CONTROLS UNIT OF ELECTRO SWITCH CORP AND ITS SUBSIDIARIES. ARCA CONTROLS IS LOCATED AT 15-1000-250A. ANY PARTY ACCEPTING THIS DOCUMENT DOES SO IN CONFIDENCE AND AGREES THAT IT SHALL NOT BE DUPLICATED IN WHOLE OR IN PART, NOR DISCLOSED TO OTHERS, WITHOUT THE CONSENT OF ARCA CONTROLS UNIT OF ELECTRO SWITCH CORP OR SUBSIDIARY.

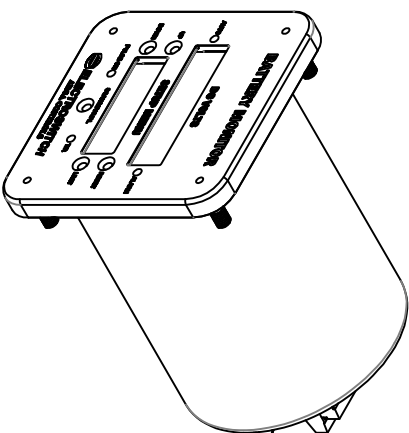
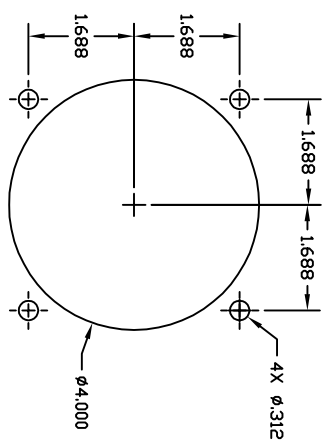
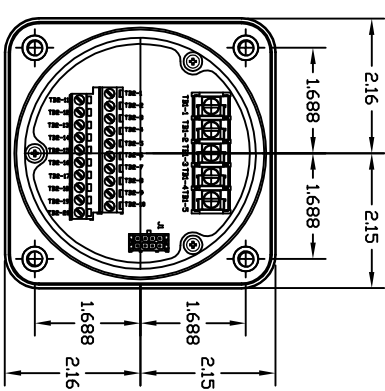
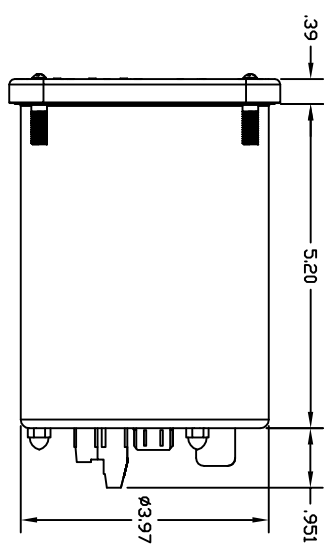
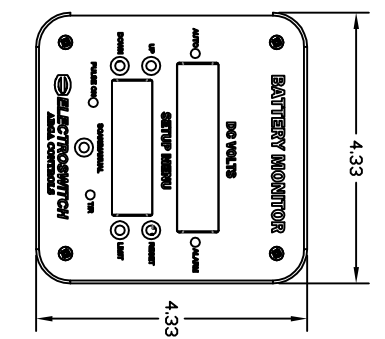

REVISIONS				
REV	DESCRIPTION	BY	DATE	APPROVED
0	PRODUCTION RELEASE	ALE	11/19/18	ALE
A	ECN# 31481 Added Notice on page 1 and added new P/N for note 10, and 12	ALE	11/19/18	EM

PARTS LIST			
QTY	RECD	CAGE CODE	PART OR IDENTIFYING NO.
UNLESS OTHERWISE SPECIFIED: DIMENSIONS ARE IN INCHES TOLERANCES DECIMALS .005 ANGULAR .5 DO NOT SCALE DRAWING UNLESS OTHERWISE SPECIFIED THE SURFACE FINISH OF MACHINED PARTS SHALL NOT EXCEED A MAX READING OF .125 PER ANSI B46.1-1978			
APPROVALS			
DRAWN	DATE	TITLE	
MK	9/04/18	BATTERY VOLTAGE/GND METER	
CHECKED	DATE	TITLE	
ALE	9/04/18	ALARM RELAY 250VDC	
ENGNG	DATE	TITLE	
ALE	9/04/18	ALARM RELAY 250VDC	
THIRD ANGLE PROJECTION			
SCALE: 1/1			
CAGE CODE: 50290			
DWG NO.: 25-1000-250A			
CAD FILE: 25-1000-250A REV A			
SHEET 1 OF 3			

NOTES: UNLESS OTHERWISE SPECIFIED

BATTERY VOLTAGE/GND METER ALARM RELAY 250VDC

25-1000-250A

SHEET 2 OF 3

1. BATTERY INPUT: 100 TO 360 VDC, 5 VA
2. GROUND RESISTORS: 60.5 KΩ, ± 1%.
3. DISPLAYED MEASUREMENTS:
 - A: BATTERY VOLTAGE
 - B: +BUS TO GROUND
 - C: -BUS TO GROUND
 - D: GROUND FAULT VOLTAGE (GFV)
 - E: RIPPLE VOLTAGE (RVV)
 - F: RIPPLE CURRENT (W/ OPTIONAL SENSOR) (RIV)
 - G: TIME DELAY (SEC) (TD)
 - H: CHARGER PHASE (1Φ OR 3Φ)
4. ANNOTATION AND CONFIGURATION DISPLAY.
 - FORMAT: 0 TO 400 VDC, BRIGHT RED LED NUMERIC DISPLAY, PLUS FIVE LETTER
5. SCANNING:
 - IN MANUAL MODE MEASUREMENT IS SELECTED BY BRIEFLY PUSHING THE SCAN/SELECT BUTTON.
 - IN SCAN MODE THE DISPLAY CYCLES THROUGH ALL SIX MEASUREMENTS, PLUS TIME DELAY AND AC CHARGER PHASE..
 - MODE IS CHANGED BY HOLDING IN THE SCAN BUTTON.
6. ALARMS:
 - ALARMS LEVELS ARE SET USING THE CONFIGURATION MENU. SEE PRODUCT USER MANUAL FOR DETAILS.
 - ALARM RELAYS ARE FORM C CONTACTS.
 - RELAY 1: + GROUND FAULT
 - RELAY 2: - GROUND FAULT
 - RELAY 3: HIGH BATTERY VOLTAGE
 - RELAY 4: LOW BATTERY VOLTAGE, OPEN BATTERY, LOSS OF AC TO CHARGER.
 - TIME DELAY: ALARM DELAY CONFIGURABLE FROM 1 TO 60 SECONDS.
7. RESET:
 - IN LATCH MODED THE ALARM IS ONLY CLEARED BY THE FRONT PANEL RESET BUTTON, OR BY REMOTE RESET. REMOTE RESET IS TRIGGERED BY CONNECTING TB2-20 TO TB1-4.
 - IN NON-LATCH MODE THE ALARM CLEARS FOLLOWING THE REMOVAL OF THE FAULT CONDITION AFTER THE TIME DELAY.
8. CONTACT RATING 2A AT 120 VAC OR 28 VDC. 25 mA AT 125 VDC.

9. INPUT/OUTPUT:
 - FOUR FORM C ALARM OUTPUTS.
 - 4-20 MA OR 0-1 MA ANALOG OUTPUT
 - MODBUS OR DNP 3 SERIAL INTERFACE.
 - OPTIONAL GROUND FAULT LOCATOR:
 - HANDHELD GROUND DETECTOR WITH P/N: 25-1100-GF.
 - DETECTOR PULSE TURNED ON/OFF USING FRONT PANEL.
 - OPTIONAL HIGH IMPEDANCE MEASUREMENT FOR CORROSION DETECTION WITH OPTIONAL CURRENT SENSOR P/N: 25-1100-H1.
 - OPTIONAL ANNUNCIATION PORT J1 FOR EXTERNAL LEDS INDICATING ±GROUND FAULT,HIGH VOLTAGE, LOW VOLTAGE, EXCESS RIPPLE VOLTAGE AND LOSS OF AC TO CHARGER.
 - FOR DNP AND MODBUS SERIAL COMMUNICATIONS PROTOCOLS SEE THE PRODUCT USER MANUAL.
 - ALARMS SETTING AND OPERATION PARAMETERS SEE TABLE 1.

TABLE 1

	BATTERY VOLTS	GROUND FAULTS VOLTS	BATTERY HIGH VOLTS	BATTERY LOW VOLTS	RIPPLE VOLTAGE mV	RIPPLE CURRENT mA	TIME DELAY SECONDS
FACTORY SETTING	250	+/-27	277	210	200	10	2.0
RANGE	100-360	+/-26-200	250-300	200-250	5-2000	5-2000	1-60

REAR CONNECTIONS	
TERMINAL	FUNCTION
TB1-1	AC LINE
TB1-2	AC NEUTRAL
TB1-3	EXTERNAL GROUND
TB1-4	BATTERY MINUS
TB1-5	BATTERY PLUS
TB2-1	RELAY 4 N.O
TB2-2	RELAY 3 N.C
TB2-3	RELAY 3 COMMON
TB2-4	RELAY 3 N.O
TB2-5	RELAY 2 N.C
TB2-6	RELAY 2 COMMON
TB2-7	RELAY 2 N.O
TB2-8	RELAY 1 N.C
TB2-9	RELAY 1 COMMON
TB2-10	RELAY 1 N.O
TB2-11	RELAY 4 COMMON
TB2-12	RELAY 4 N.C
TB2-13	RS485 A
TB2-14	RS485 B
TB2-15	RS485 SHIELD
TB2-16	4-20 / 0-1 MA OUTPUT
TB2-17	4-20 / 0-1 MA RETURN
TB2-18	CURRENT SENSOR +
TB2-19	CURRENT SENSOR -
TB2-20	RESET: SHORT TO BATTERY - TO RESET MONITOR

